

Swing Type Check Valve

Product Information

VinFlow swing check valve prevents back flow of the medium. The disc opens automatically, if the medium flows in the direction indicated by the arrow on the valve body.

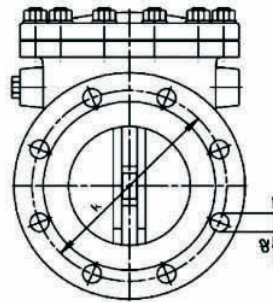
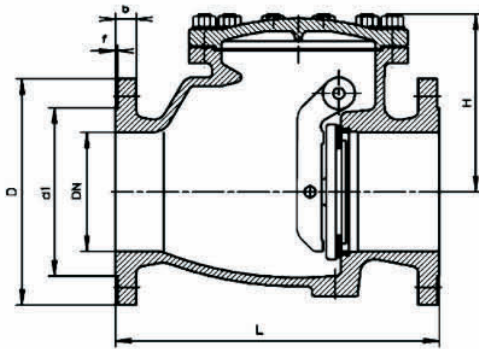

Main Materials

Serial No.	Part	Material
1	Body	Cast Iron (GG 25)/ DI(GGG 40) with epoxy coating 300 microns
2	Cover	Cast Iron (GG 25)/ DI(GGG 40)
3	Disc	Cast Iron (GG 25)/ DI(GGG 40)
4	Hinge	Cast Iron (GG 25)/ DI(GGG 40)
5	Seat ring	Brass/Bronze
6	Disc ring	NBR or EPDM, Suitable for potable water

Other materials not mentioned above are available on request

Technical Parameters

Pressure rating : PN 10/PN 16

Service : Water, Sewage, Irrigation

Face to face : DIN 3202 T1 - F6

Opening pressure min 0.03bar

Closing Pressure min.0.1 bar

Flange Drilling : PN10/PN16

Installation Instructions:

In general Non return valves are designed to be installed in horizontal pipe lines. An installation in sloping and vertical pipe lines is possible if the flow of the medium is upwards.

Direction of flow has to be according to the arrow indicated on the body. Axle of the disc shaft has to be fully horizontal

Main Dimension in (mm)

DN	D	D1	D2	L	b	H	n-ød
50	165	125	102	200	20	136	4-Ø18
65	185	145	122	240	20	147	4-Ø18
80	200	160	138	260	22	158	8-Ø18
100	220	180	158	300	24	184	8-Ø18
125	250	210	188	350	26	212	8-Ø18
150	285	240	212	400	26	227	8-Ø22
200	340	295	268	500	30	263	12-Ø22
250	405	355	320	600	32	304	12-Ø26
300	460	410	378	700	32	335	12-Ø26
350	520	470	438	800	36	355	16-Ø26
400	580	525	490	900	38	394	16-Ø30