

CLASS 150

ITEM	Size	L	B	G	K	D	C	n-d
	2"	203	49	92	120.7	150	15.8	4-19
	3"	241	74	127	152.4	191	19.1	4-19
	4"	292	100	157	190.5	229	22.9	8-19
	6"	406	150	216	241.3	279	25.4	8-22

ITEM	NAME	MATERIAL
1	NUT	ASTM A194 2H
2	STUD	ASTM A193 B7
3	COVER	ASTM A105
4	GASKET	304+FLEXIBLE GRAPHITE
5	SCREEN	SS304
6	BODY	ASTM A216 WCB
7	Drain plug	ASTM A105

DESIGN STD.	ASME B16.34	END CONN.	RF
PRES. & TEMP.	ASME B16.34	PRES. TEST	API 598
FACE TO FACE	ASME B16.10	END DIM.E.	ASME B16.5
MARKING	MSS SP-25	F.S. DESIGN	
PAINTING		SPECIAL	

REV. NO.	MARKING	SIGNATURE	DATE	TYPE?
DESIGN				BASKET STRAINER CLASS 150
APPROVE				
DATE				

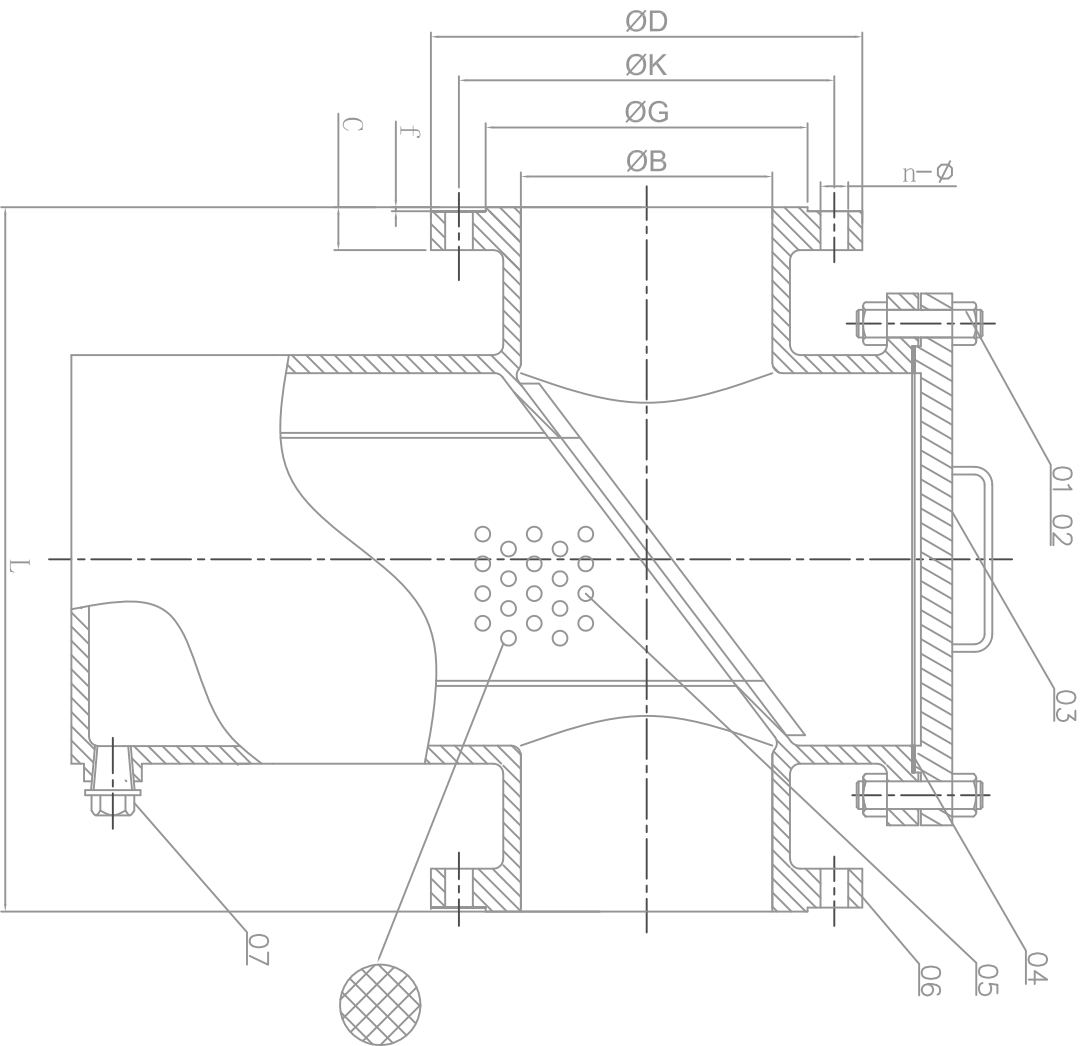

CLASS 150

ITEM	Size	L	B	G	K	D	C	n-d
	8"	495	201	269.7	298.5	343	28.4	8-22.2
	10"	622	252	323.9	362	406	30.2	12-25.4

ITEM	NAME	MATERIAL
1	NUT	ASTM A194 2H
2	STUD	ASTM A193 B7
3	COVER	ASTM A105
4	GASKET	304+FLEXIBLE GRAPHITE
5	SCREEN	SS304
6	BODY	ASTM A216 WCB
7	Drain plug	ASTM A105

DESIGN STD.	ASME B16.34	END CONN.	RF
PRES. & TEMP.	ASME B16.34	PRES. TEST	API 598
FACE TO FACE	ASME B16.10	END DIM.E.	ASME B16.5
MARKING	MSS SP-25	F.S. DESIGN	
PAINTING		SPECIAL	

REV. NO.	MARKING	SIGNATURE	DATE	TYPE: BASKET STRAINER CLASS 150
DESIGN				
APPROVE				
DATE				